

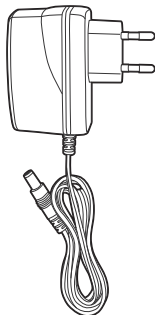

Aranet PRO base station

Quick start guide

1.

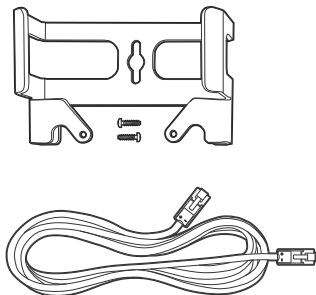
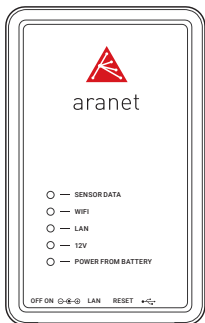

2.

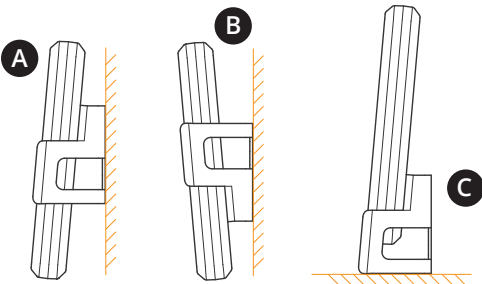
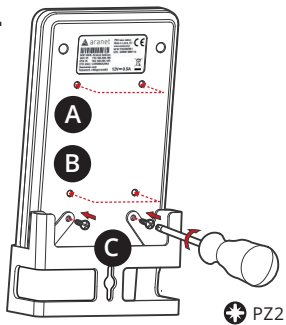

3.

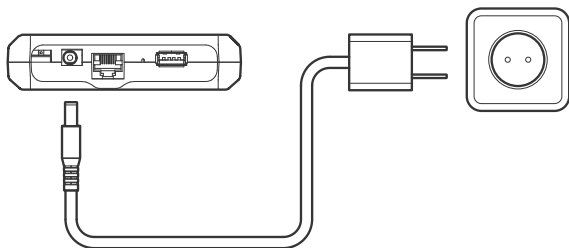

4.

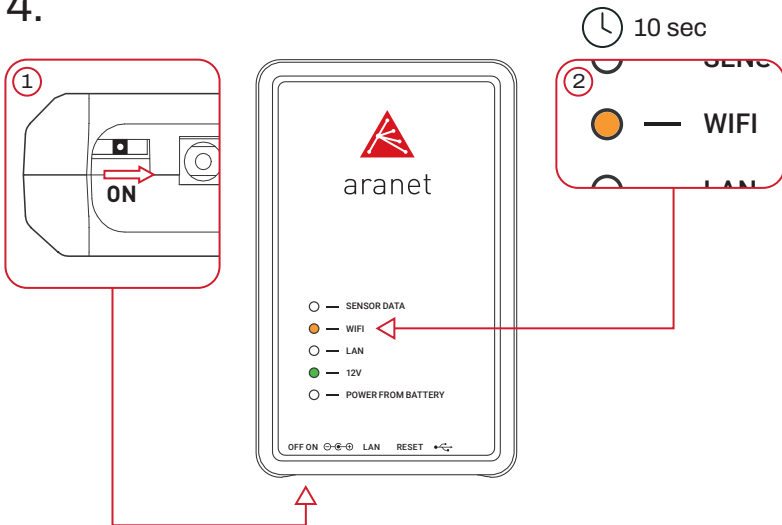

5.

Diagram illustrating step 5 of the setup process. Three red boxes show configuration steps:

- 1. WiFi SSID: Aranet-*****
- 2. URL: http://192.168.206.100
- 3. Login screen with fields for Username (root) and Password (*****), and a 'Remember me' checkbox.

On the right, a product information label for the Aranet device is shown, including:

- aranet logo
- PRO base station
- Made in Latvia, EU
- www.aranet.com
- M/N: TDSBWB01
- S/N: 349681000113
- CE mark
- Barcode
- WiFi SSID: Aranet-5e63aa
- WiFi IP: 192.168.206.100
- ETH IP: 192.168.205.100
- ETH MAC: C493000A2592
- Username: root
- Password: nMbgvcwxM3
- 12V == 0.5A
- WEEE recycling symbol

Smarter
than others



SCAN THE QR CODE TO SEE
PRO BASE USER GUIDE

© 2017 – 2022 SAF TEHNIKA JSC
ALL RIGHTS RESERVED.

ARANET.COM